

T



TIP TUTORIAL

Using Different Door Styles and Hardware on the Same Cabinet

INTRODUCTION

Chief Architect X9 has added the ability to have different door styles and different hardware on the same cabinet. In this tutorial we will be working with wall cabinets, but what you will learn can be applied to full height cabinets as well.

APPLYING DIFFERENT DOOR STYLES AND HARDWARE TO THE SAME CABINET

1. If you have Chief Architect running select **File ► New Plan**. If the program is not running, then go ahead and start Chief Architect and select **New Plan** from the **Welcome to Chief Architect** splash screen.
2. Using the  **Wall Cabinet** tool, place a wall cabinet in the plan view.
3. Take a  **Cross Section /Elevation** view of the cabinet.

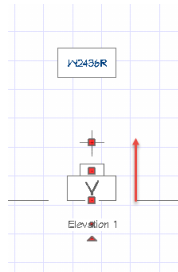

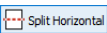
4. In the elevation view, double-click the cabinet to open its specification dialog. Go to the **General** panel. Change the **Height** to **51"**, and the **Width** to **30"**. The **Depth** should be **12"**.
5. Go to the **Front/Sides/Back** panel. In the **Cabinet Side** section, **Front** should be selected for the **Side**. Select **Custom Face** for the **Side Type**. In the graphic preview, click on the door (or select **2-Door** from the **Face Items** list. Click the  **Split Horizontal** button. You should see double doors in both the top half and bottom half of the cabinet.
6. With the upper doors selected, change the **Item Height** to **18"**.

Applying Different Door Styles and Hardware to the Same Cabinet

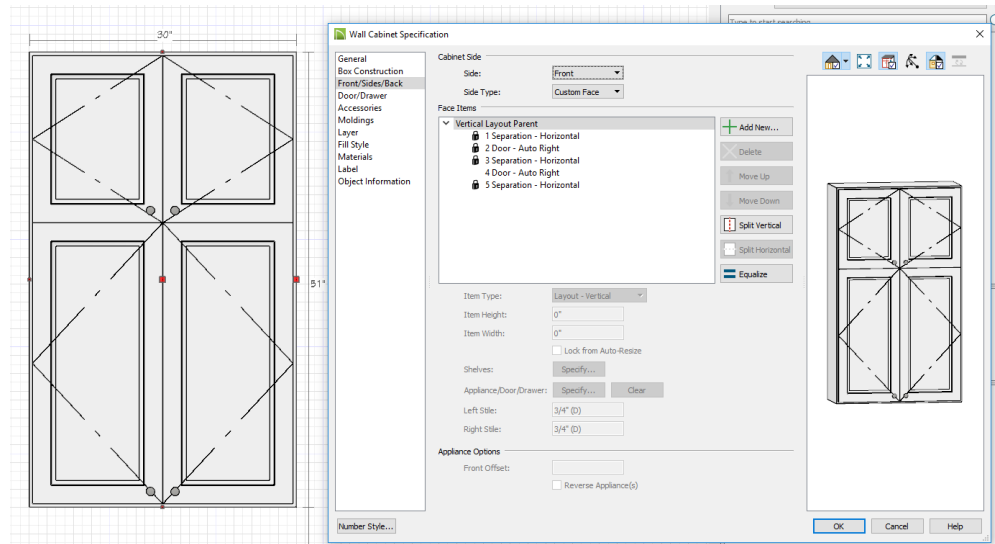

7. Go to the **Door/Drawer** panel. In the **Door** section, select **Framed Doors** from the **Style** drop-down list.
8. Check the check box for **Glass Doors**. Since both the upper and lower doors are exactly the same both of the doors will change to be glass doors. We want to change just the upper doors. Uncheck **Glass Doors**. In the preview window, click on the upper doors. You are taken to the **Front/Sides/Back** panel of the dialog. We want to change the style of the upper doors so that they are different than the lower doors.
9. Click the **Specify** button for **Appliance/Door/Drawer**. You may get in **Information** panel. Read it and click **OK** to close it. The **Door Face Item Specification** dialog displays. Select **Framed Doors** from the **Door Style** drop-down list. Note that you also have the option to select a different door style from the **Library**. Check the check box for **Glass Doors**. Because we made this door different than the lower door, this door (the upper door) is now the only glass door. Click **OK** to close the **Door Face Item Specification** dialog.
10. With the upper doors selected, select **Door-Hinged Top** from the **Item Type** drop-down list. Note that the door handle needs to be moved to a more appropriate location for this type of door.

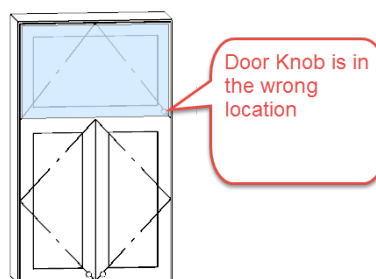

11. With the upper doors selected, click the **Specify** button for **Appliance/Door/Drawer**. The **Door Face Item Specification** dialog displays. Look at the **Door Handle** section. Click on the **Library** button. The **Select Library Object** dialog displays. Select **Chief Architect Core Catalogs** ⇒ **Architectural** ⇒ **Hardware** ⇒ **Cabinet Hardware** ⇒ **Pulls**. Select the door pull of your choice. Click **OK**.
12. In the **Door Handle** section, change the value for **In From Edge** to **0**. This will place the handle in the center of the door. **1 3/8"** should be the value for **Up From Bottom**. Click **OK**.

In this tutorial, we only used one cabinet to make changes too. However, the procedure would be the same if you had multiple wall cabinets that you wanted to change. Just group-select the cabinets you want to make the same changes to, and open the specification dialog by clicking the  Open Object edit tool button.